

DESIGNED TO MOVE [YOU][®]

Product Change Notice V2

In order to ensure our products continue to evolve as the technological market changes, ASA Electronics will be updating our line of JENSEN[®] televisions as follows:

The JENSEN[®] JTV4020DC will be replacing the JENSEN[®] JTV4015DC 40-inch LED DC Television. This change will take effect when current supply is exhausted.

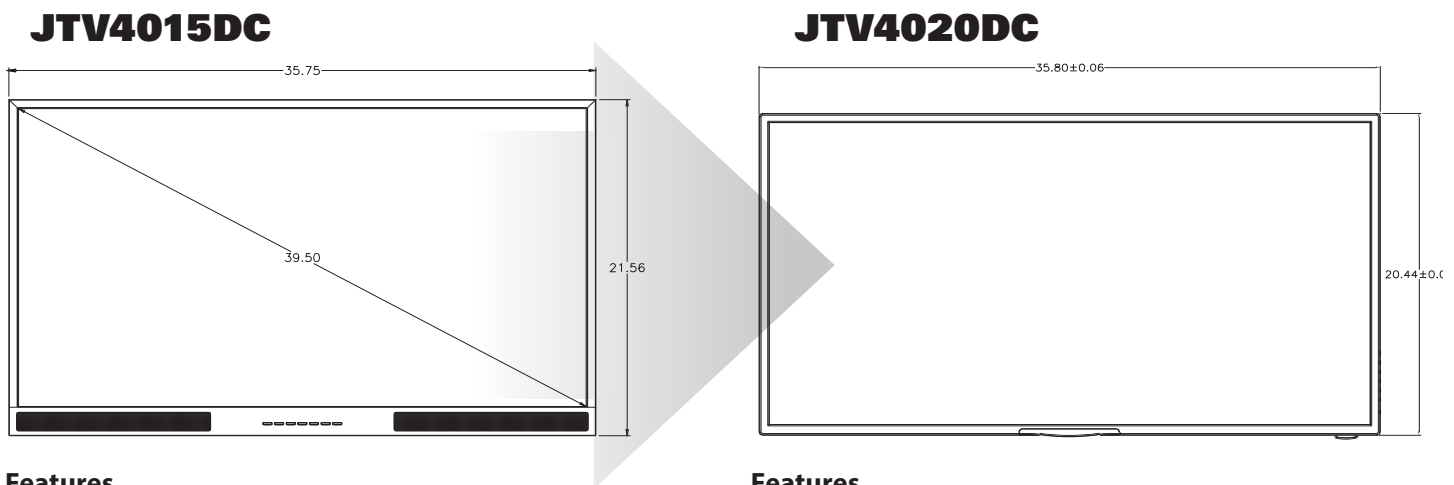

Features

- DC Power
- VESA 200mm x 100mm Mounting Pattern
- Dual function (TV & DVD) wireless remote control included
- DC Power Cord Included
- Conformal Coated Circuit Boards
- Front Controls
- Table Top Stand Optional (STDJTV4015DC)

Inputs/Outputs

- Composite Video Input x 1 (NTSC/PAL compatible)
- Component Video Input x 1 (YPbPr)
*Note: Composite/component input shares same I/O
- Stereo Audio Input x 1
- RF x 1
- USB x 1
- HDMI input x 1
- Selectable (Variable/Fixed) Line Level Audio Output (RCA) x 1
- Digital SPDIF Audio Output (RCA) x 1

Features

- DC Power
- White LED Illumination
- High Performance Wide 16:9 LCD panel
- **VESA 200mm x 200mm Mounting Pattern**
- Dual function (TV & DVD) wireless remote control included
- DC Power Cord Included

Inputs/Outputs

- Composite Video Input x 1 (NTSC/PAL compatible)
- Component Video Input x 1 (YPbPr)
*Note: Composite/component input shares same I/O
- Stereo Audio Input x 1
- RF x 1
- USB x 1
- **HDMI input x 2**
- Selectable (Variable/Fixed) Line Level Audio Output (RCA) x 1
- Digital SPDIF Audio Output (RCA) x 1



DESIGNED TO MOVE [YOU][®]

Product Change Notice V2

JTV4015DC

JTV4020DC

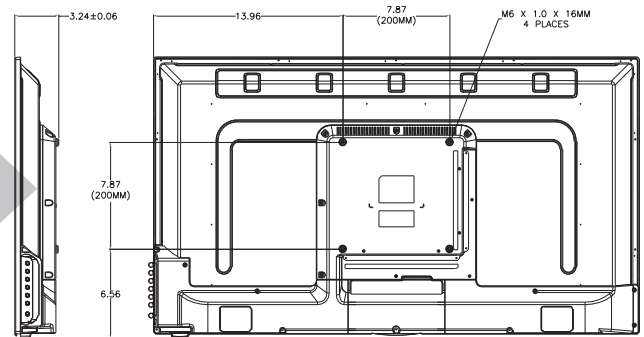
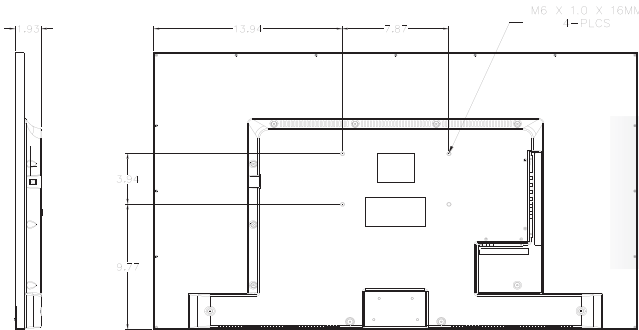

Specifications:

General Specifications:

| | | |
|-----------------------------|--|---------------|
| Power System | DC 12V | |
| Power Consumption | 20 mA stand by | 5.41 A max |
| Operating Temperature Range | -4°F to 149°F | -20°C to 65°C |
| Storage Temperature Range | -22°F to 158°F | -20°C to 70°C |
| Maximum Relative Humidity | 85% | |
| Overall Dimensions | 35.8" W x 21.6" H x 1.9" D (without stand) | |
| Product Weight (unpackaged) | 22 lbs. 8 oz. | |
| Regulatory Certification(s) | FCC | |

Performance Specifications:

| | | | |
|--------------------------------|-----------------|-------------|-------|
| Video / Display System | NTSC/ATSC/PAL | | |
| Video Input Signal (Composite) | 1Vp-p @ 75 ohms | | |
| Audio Output | 8W x 2 | | |
| LCD Specifications | Diagonal Size | 39.5" | |
| | Resolution | 1920 x 1080 | |
| | Brightness | 200 nit | |
| | Contrast Ratio | 5000:1 | |
| | View Angles | Top | 89° |
| | | Bottom | 89° |
| | | Left | 89° |
| | | Right | 89° |
| | Display Format | 16:9 | |
| | Response Time | Rise | 6.5ms |
| Fall | | | |

Specifications:

General Specifications:

| | | |
|-----------------------------|--|---------------|
| Power System | DC 12V | |
| Power Consumption | 33 mA stand by | 5.32 A max |
| Operating Temperature Range | -4°F to 149°F | -20°C to 65°C |
| Storage Temperature Range | -22°F to 158°F | -20°C to 70°C |
| Maximum Relative Humidity | 85% | |
| Overall Dimensions | 35.8" W x 20.4" H x 3.2" D (without stand) | |
| Product Weight (unpackaged) | 9.9 lbs. 8 oz. | |
| Regulatory Certification(s) | FCC | |

Performance Specifications:

| | | | |
|--------------------------------|-----------------|-------------|-------|
| Video / Display System | NTSC/ATSC/PAL | | |
| Video Input Signal (Composite) | 1Vp-p @ 75 ohms | | |
| Audio Output | 8W x 2 | | |
| LCD Specifications | Diagonal Size | 39" | |
| | Resolution | 1920 x 1080 | |
| | Brightness | 180 nit | |
| | Contrast Ratio | 5000:1 | |
| | View Angles | Top | 89° |
| | | Bottom | 89° |
| | | Left | 89° |
| | | Right | 89° |
| | Display Format | 16:9 | |
| | Response Time | Rise | 8.5ms |
| Fall | | | |

If you have any questions regarding these product changes or want information on specific pricing, please contact your ASA Electronics sales representative or Customer Service at (877) 845-8750.