



DESIGNED TO MOVE [YOU]<sup>®</sup>

# Marine Remotes



## MWR75 Waterproof Wired Remote

- Compatible with all JENSEN marine remote ready stereos
- Waterproof design (IPX6 rated)
- LED backlit controls
- UV-resistant finishes/materials (meets ASTM D4329)
- Corrosion-resistant materials (meets ASTM B117)
- 2" through hole mount
- Optional U-bracket mounting kit
- 18 ft. extension cable included
- FCC/CE certified
- Dimensions: 2-1/2" Diameter x 2"D



## MWR100 Waterproof Display Remote

- Compatible with all JENSEN marine satellite ready stereos
- Waterproof design (IPX6 rated)
- 2-7/8" through hole mount
- LED backlit controls
- Sunlight readable display (positive LCD)
- UV resistant materials/finishes
- Conforms to ASTM B117 (Salt fog) and ASTM D4329 (UV) standards
- Optional U-bracket mounting kit
- 18 ft. extension harness included
- FCC/CE certified
- Dimensions: 3-1/2" Diameter x 2"D



## MWR150 Waterproof Display Remote

- Compatible with MSR and MS Series stereos
- Space saving design
- Waterproof design (IPX6 Rated)
- Conformal Coated circuit boards
- White backlit controls and LED illumination
- Full function sunlight readable display
- Removable chrome trim
- UV resistant finish (meets ASTM D4329 standards)
- Corrosion resistant materials (meets ASTM B117)
- 20 ft. extension cable included
- Ignition protection certified
- Surface or in-panel mounting options

**ASAelectronics**  
THE MOBILE ELECTRONICS COMPANY SINCE 1977  
2602 Marina Drive • Elkhart, IN 46514  
[www.asaelectronics.com](http://www.asaelectronics.com)

MARINE ENTERTAINMENT

Features and specifications subject to change without notice.



# Marine Remotes

## MWR75

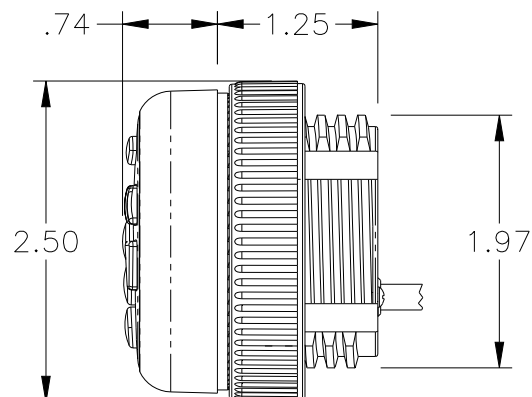
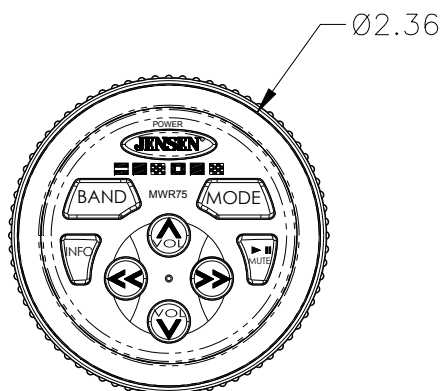

## MWR100

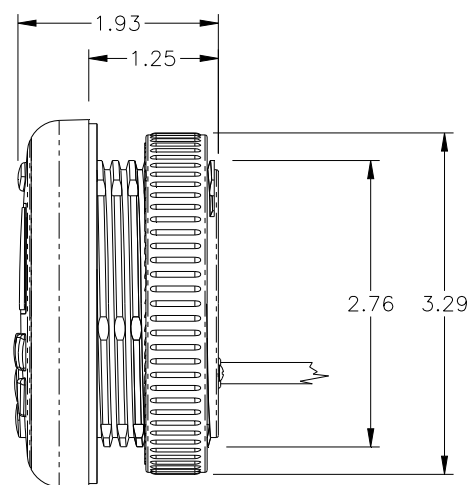
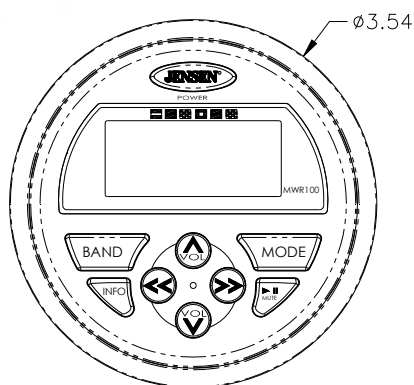

## MWR150

