

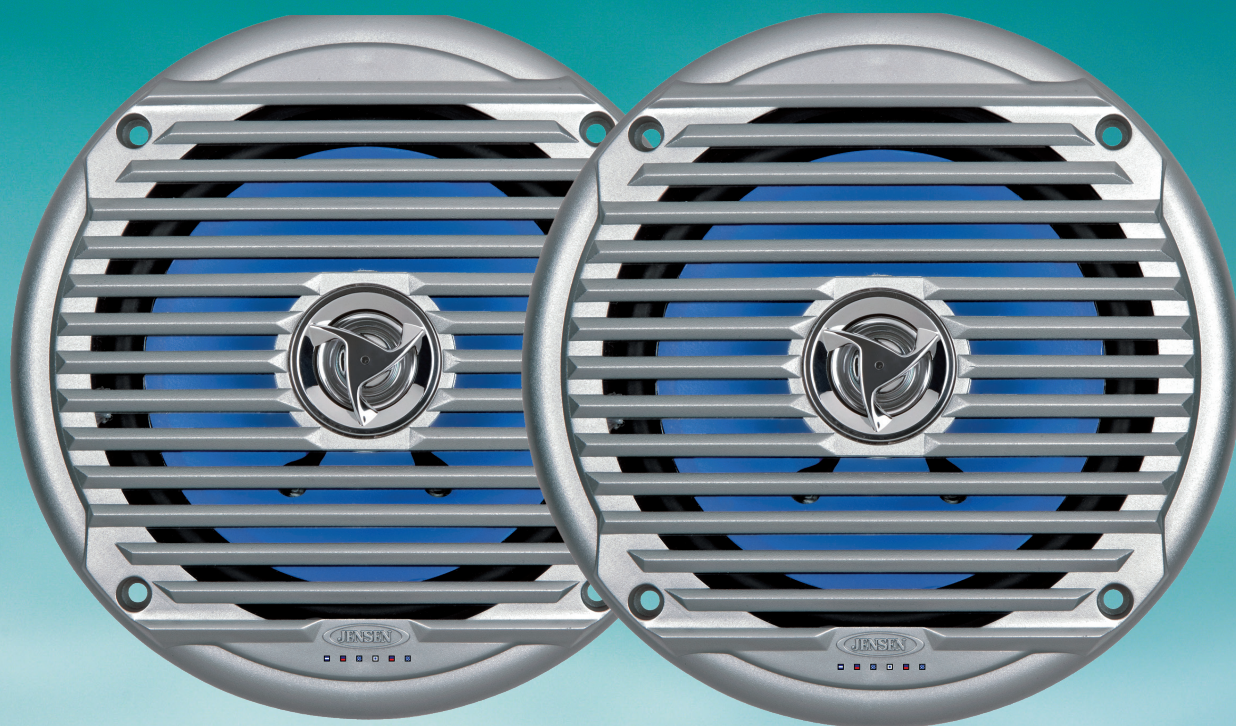

# 6.5" Waterproof High Performance Coaxial Speakers [MSX60S]



## KEY FEATURES:

- Max Power Handling: 65 Watts
- Sensitivity: 91dB
- Frequency: 65Hz-20kHz
- Nominal Impedance: 4 Ohms
- Polypropylene Woofer: 6-1/2"
- Magnet: 11 oz.
- Mounting Hole Diameter: 5"
- Mounting Depth: 2-1/3"
- Tweeter Type: Dome

- One-piece plastic chassis with integrated drip-edge
  - Voice Coil Size: 1"
  - Suspension/Surround: Rubber
  - Speaker Color:
    - MSX60S – Silver
    - MSX60W – White
- ASTM B117 Salt Spray Exposure Standard Compliant  
ASTM D4329 UV Exposure Standard Compliant

MARINE CERTIFIED

**asa**  
ELECTRONICS  
2602 Marina Drive • Elkhart, IN 46514  
[www.asaelectronics.com](http://www.asaelectronics.com)



# 6.5" Waterproof High Performance Coaxial Speakers [MSX60S]

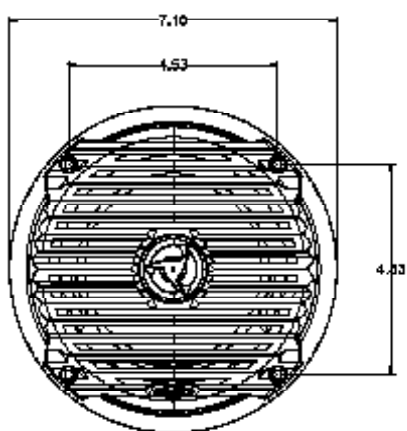

RECOMMENDED SCREW SIZE #0 PAN HEAD

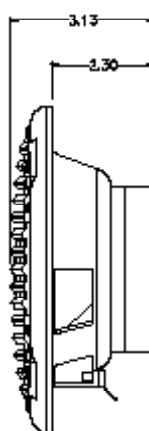

RECOMMENDED HOLE CUTOUT  
+/- TOLERANCE -0 / +.125

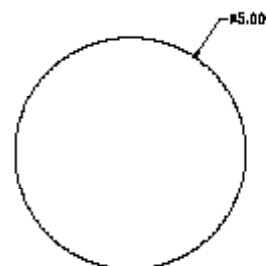

## **Specifications:**

### **General Specifications:**

Woofer Size	6.5"	
Woofer Material	Poly-propylene	
Suspension Surround	Rubber	
Tweeter Type	Dome	
Tweeter Material	Titanium	
Voice Coil Size	1"	
Magnet Weight	11oz	
Mounting Depth	2.3"	
Hole Size	5"	
Impedance	4 Ohms	
Temperature Range	-30°C - 70°C	-22°F - 158°F
Max RH	100%	
Terminal Size	Positive - 1/4"	Negative - 3/16"

### **Performance Specifications:**

Frequency Response	65 Hz - 20 KHz	
RMS Power Range	25W	
Max Input Power	50W	