



6.5" Coaxial Speaker
MSX60



PRODUCT FEATURES

- Max power input: 75 watts
- Frequency response: 65Hz - 20KHz
- Bridged/suspended tweeter
- Polypropylene cone
- Rubber suspension/surround
- Magnet weight: 11 oz.
- High polished chrome grille
- Water and corrosion resistant sealed design
- All plastic chassis construction
- UV resistant (ASTM D4329)
- Hole size: 5"
- Mounting depth: 2.3"
- Available in Chrome (MSX60CP)
or Black (MSX60B)

DESIGNED TO MOVE [YOU]™

asa
ELECTRONICS™
2602 Marina Drive • Elkhart, IN 46514
www.asaelectronics.com



6.5" Coaxial Speaker MSX60

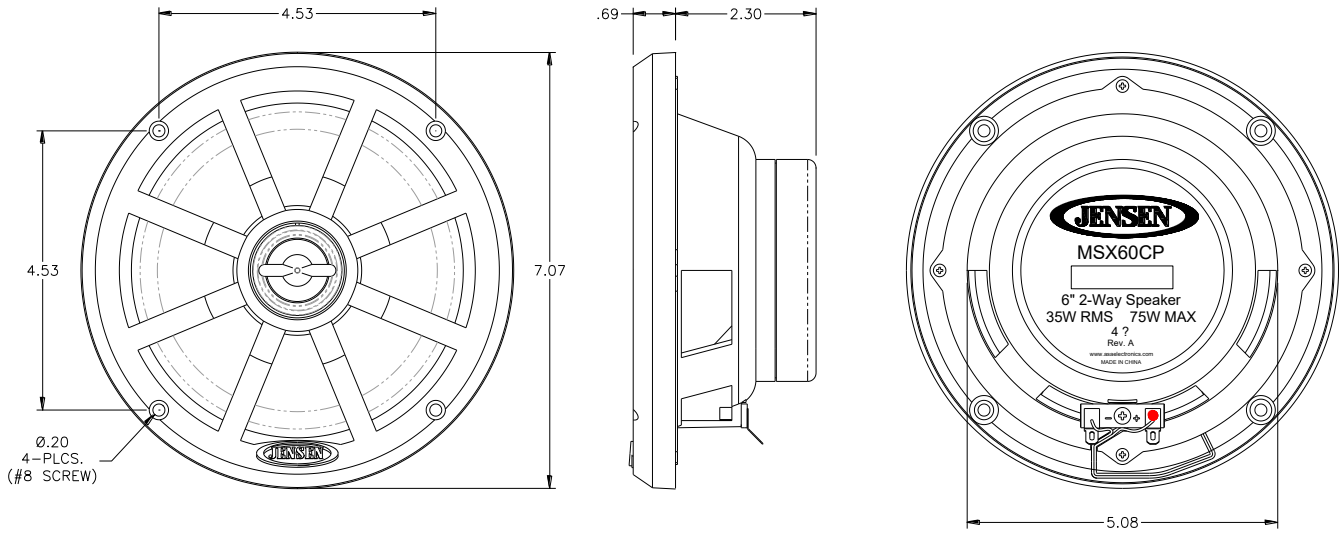

Specifications:

General Specifications:

| | | |
|-------------------|-----------------|------------------|
| Woofer Size | 6" | |
| Woofer Material | Polypropylene | |
| Tweeter Type | Dome | |
| Tweeter Material | Silk | |
| Voice Coil Size | 1" KSV | |
| Magnet Weight | 11oz | |
| Mounting Depth | 2.3" | |
| Hole Size | 5" | |
| Impedance | 4 Ω | |
| Temperature Range | -30°C - 70°C | -22°F - 158°F |
| Max RH | 100% | |
| Terminal Size | Positive - 1/4" | Negative - 3/16" |

Performance Specifications:

| | |
|--------------------|----------------|
| Frequency Response | 65 Hz – 20 KHz |
| RMS Power | 35W |
| Max Power | 75W |
| SPL @ 1 W/ 1 M | 89 dB |
| Resonant Frequency | 75 Hz |