

KMC2

APP READY MARINE STEREO



COMMANDER & MODULE

- 2.8" Color TFT display viewable in direct sunlight
- Max output power: 50W x 4 with MOSFET Power IC
- 2-Wire power system: 12V DC
- 4 Zone volume controls (when connected to KMC1DSP)
- Non-volatile memory
- NOAA 7-Channel weather band
- Bluetooth (A2DP streaming audio: AVRCP remote control)
- Made for iPod/iPhone (via Bluetooth)
- USB 2.0 for playback of MP3 and WMA audio files
- EQ Presets
- Front and rear channel RCA pre-amp outputs
- Auxiliary audio RCA input
- Water resistant front panel commander (IPX6)
- Water resistant tuner/amp chassis (IPX5)
- JDAB wired remote ready (DMC2RC)
- 4V Differential audio output (KMC1DSP)
- Low battery warning
- Conformal coated PCB
- UV resistant (ASTMD4329) and Corrosion resistant (ASTMD1141)

PRELIMINARY

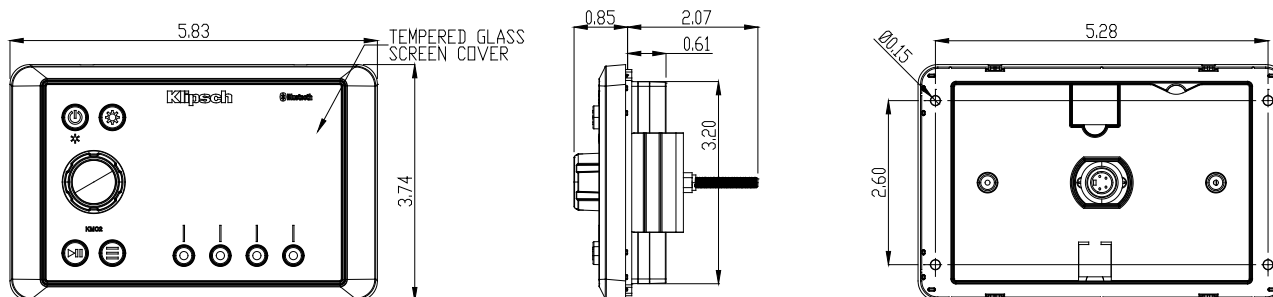

Specifications		
General Specifications		
Power System		12 V DC
Operating Voltage Range		10V to 16V
Current Draw @ 12V	Quiescent	0 A
	Nominal	1.4 A
	Maximum	15 A
Operating Temperature Range		-14°F to 149°F -20°C to 65°C
Storage Temperature Range		-22°F to 158°F -30°C to 70°C
Maximum Relative Humidity		100%
Overall Package Dimensions		7.4 x 7.4 x 2.2 Tuner/Amp 5.7 x 3.6 x 1 Commander
Product Weight (unpacked)		2.5 lbs.
Performance Specifications		
FM Sensitivity		14 uV
AM Sensitivity		30 uV
Output Power	RMS @ 1% THD	26W per channel
	Maximum	50 x 4W
Total Harmonic Distortion (at rated power)		0.1%
Applied Test Suite		ASA ES0001
Regulatory Certification		FCC Part 15B, CE RED, RoHS

PRELIMINARY